

1 SHARED TRNECH DETAIL

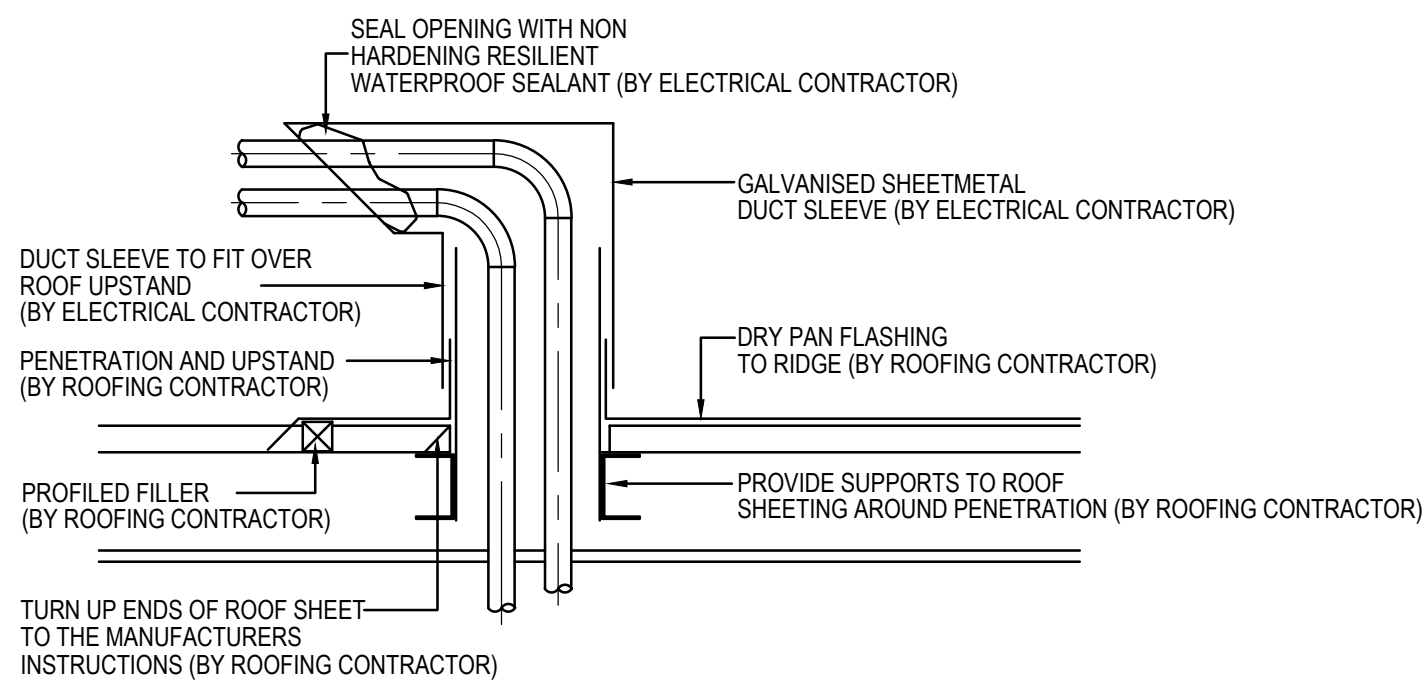

- NOTES:
1. ALLOW TO COORDINATEWORKS WITH ROOFING CONTRACTOR

3 TYPICAL ROOF CABLE PENETRATION DETAIL

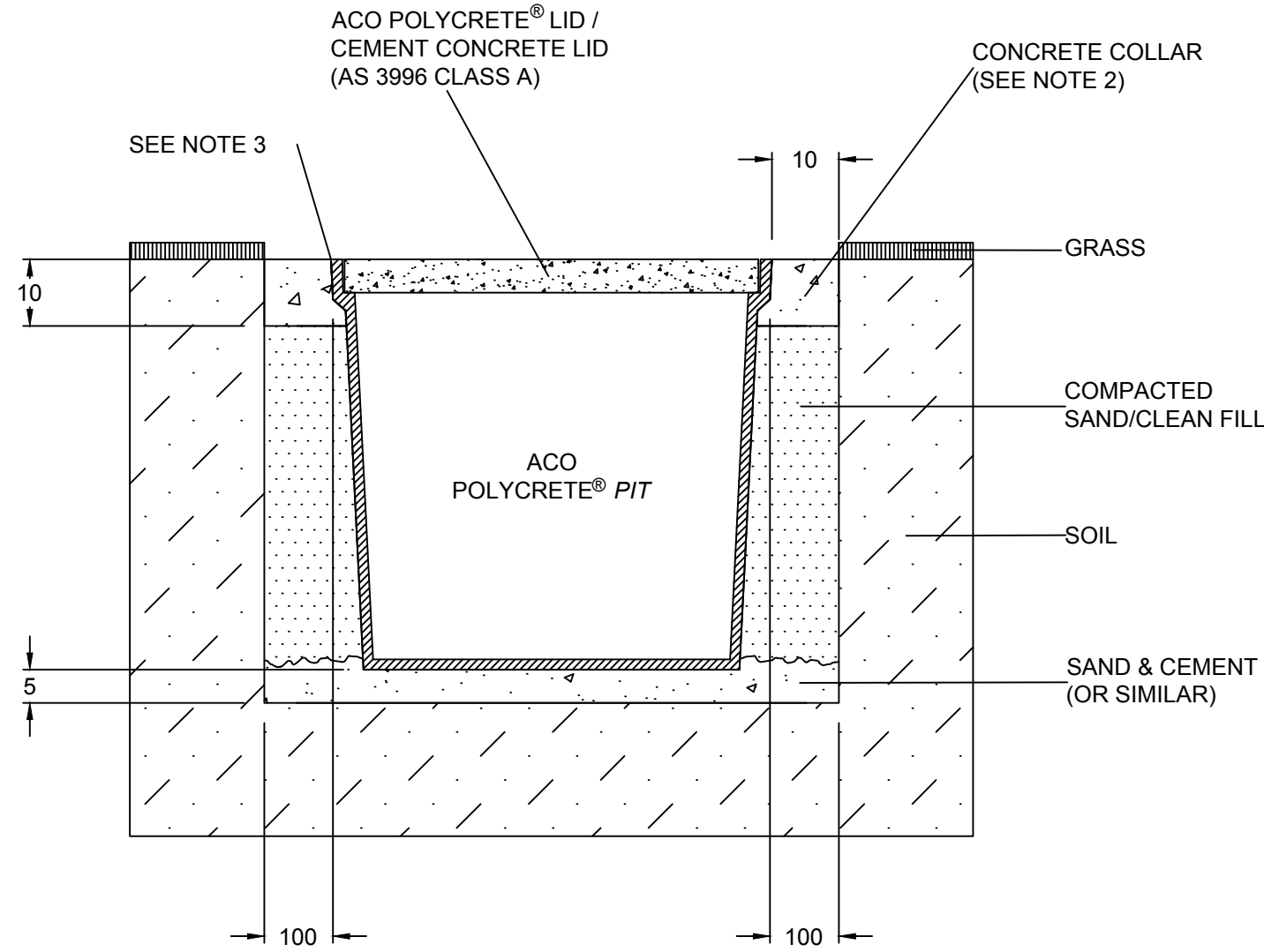

- NOTES:
1. SPECIFIC SITE CONDITIONS MAY REQUIRE AN INCREASE IN THESE DIMENSIONS OR REINFORCEMENT. IT IS THE CUSTOMER'S RESPONSIBILITY TO ENSURE THE INSTALLATION DRAWING IS DETAILED FOR THE APPLICATION AND PIT STRUCTURE IS PROTECTED FROM UNDUE STRESS.
 2. CONCRETE SHOULD BE VIBRATED TO ELIMINATE AIR POCKETS.
 3. THE FINISHED LEVEL OF THE CONCRETE COLLAR MUST BE FLUSH WITH THE TOP OF THE PIT.
 4. REFER TO ACO'S LATEST INSTALLATION INSTRUCTIONS FOR COMPLETE DETAILS.

2 CABLE PIT DETAIL

DRAWINGS TO BE READ IN CONJUNCTION WITH ELECTRICAL SPECIFICATION

1	22-06-18	BUILDING RULES CONSENT	CLB	
0	18-05-18	BUILDING RULES CONSENT	CLB	
Rev	Date	Issue Description	By	
Project				
PROPOSED COMMERCIAL DEVELOPMENT 97 KING WILLIAM STREET KENT TOWN				
Title				
ELECTRICAL SERVICES POWER DETAILS				
Architect				
ANTHONYDONATOARCHITECTS Suite 5/59 Fullarton Road Kent Town SA 5087 t: 08 8364 6888 f: 08 8364 5355 www.adarchitects.com.au				
SECON consulting engineers 466 PULTENEY STREET ADELAIDE SOUTH AUSTRALIA 5000 TEL: 08 8223 7800 engineers@secon.net.au A.B.N. 30 613 300 299 A.C.N. 613 300 299				
© COPYRIGHT SECON PTY. LTD. 2017				
North	DRAWN	CLB	CHECKED	
	ENG	RB	Q.A.	AD
	DATE	MAR 18	SCALE	NTS
			SHEET	6 OF X
DRAWING No.		B8014-E06		
22/06/2018				
PLOT DATE:		Size	Rev.	
		A1	1	